

Labgear Adding DigiLink Control to a TV System with an Encoder Modulator

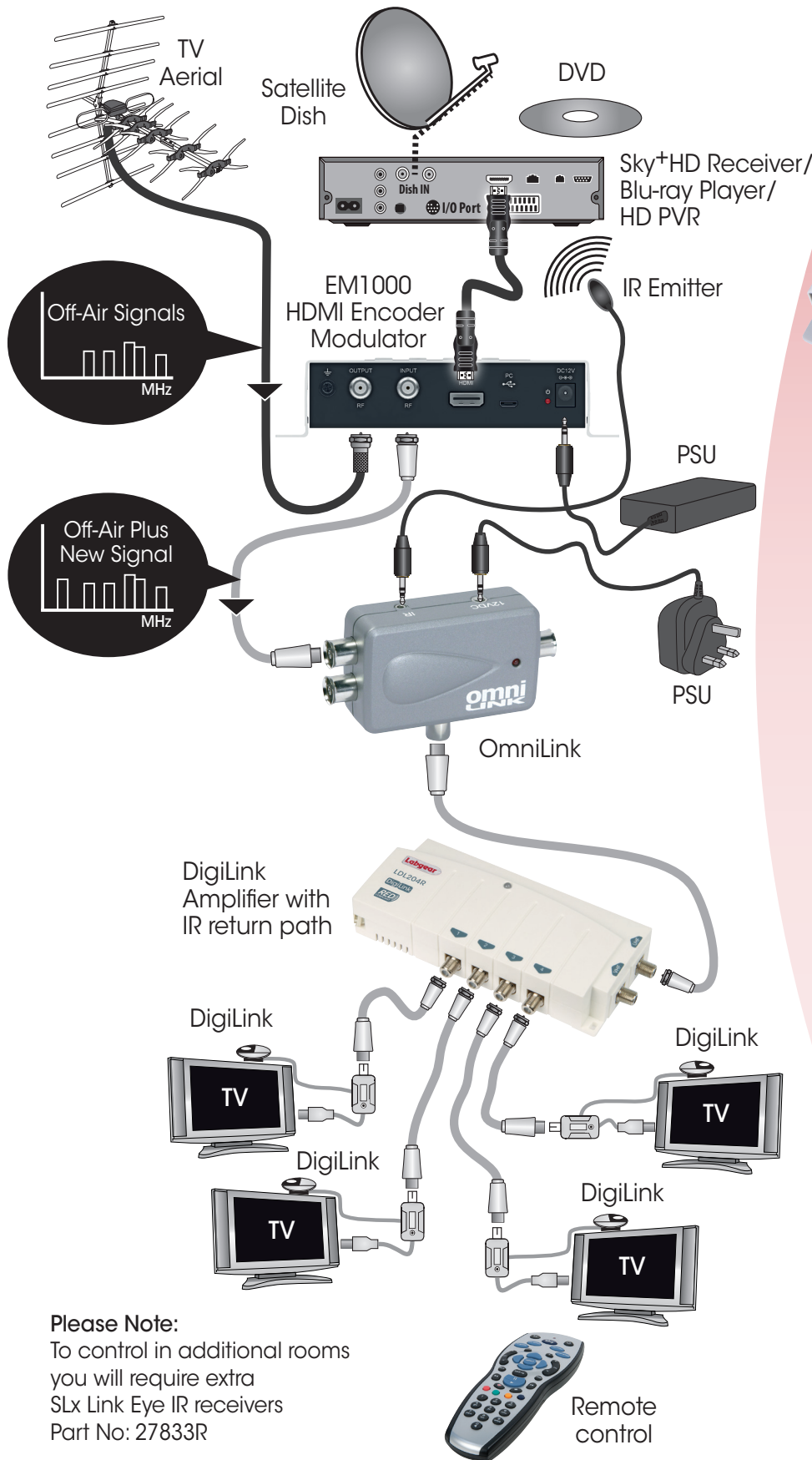

Please Note:
To control in additional rooms you will require extra SLx Link Eye IR receivers
Part No: 27833R

EM1000
HD Encoder
Modulator



OmniLink+ Kit -
Part No: 27872HS



- Kit Contents:**
- 1x OmniLink adaptor
 - 1x SLx DigiLink IR receiver
 - 1x Jack lead with 3x IR emitters
 - 1x 12V = 100mA power supply

